

SOLUCIONES (6ª SEMANA)

1. LENGUA: NO NECESITA SOLUCIONARIO.
2. SOCIALES:

Nombre:

Curso:

1. Observa y explica.

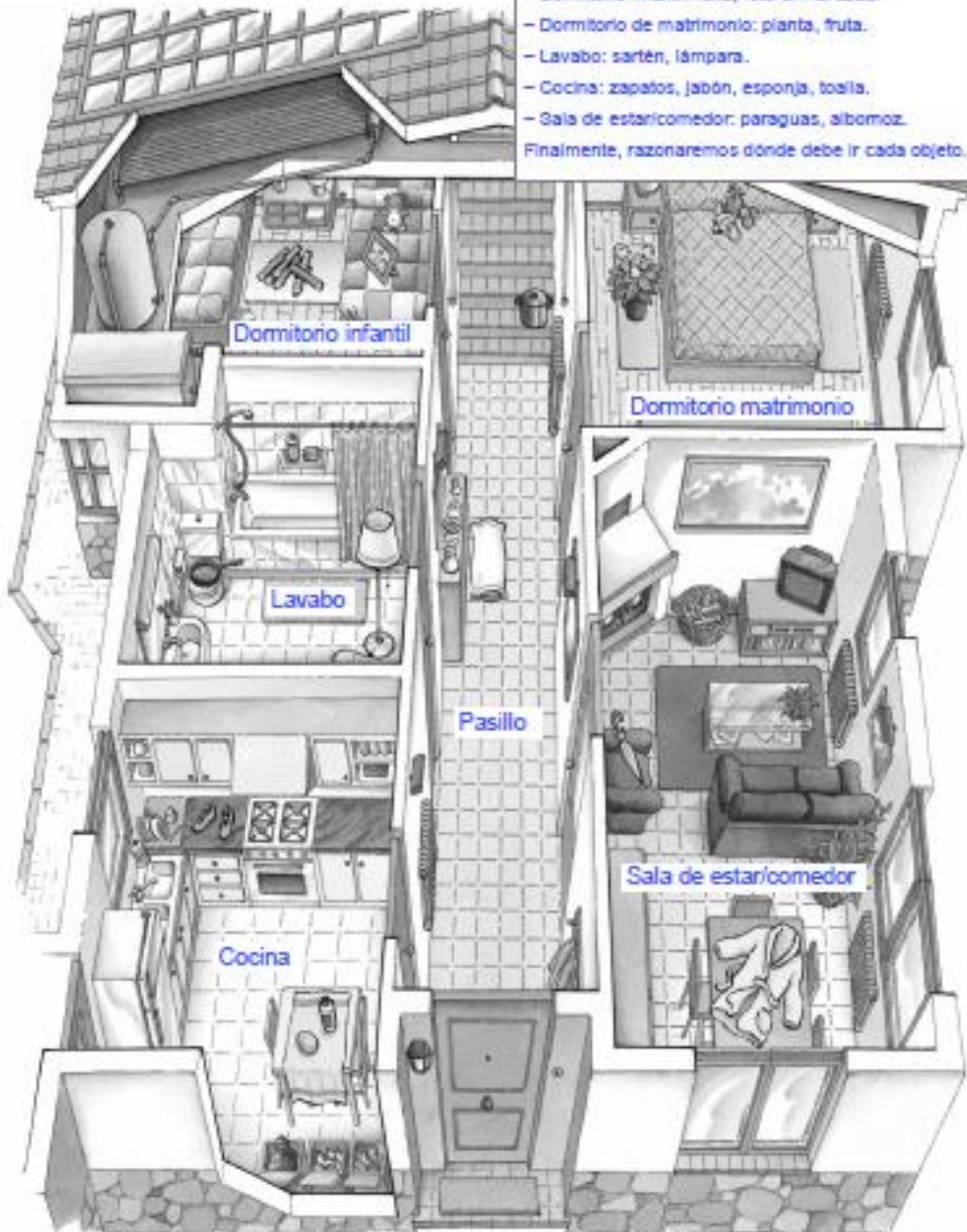

Los elementos que no están en su lugar son:

- Pasillo: olla, almohada.
- Dormitorio infantil: iefia, foto enmarcada.
- Dormitorio de matrimonio: planta, fruta.
- Lavabo: sartén, lámpara.
- Cocina: zapatos, jabón, esponja, toalla.
- Sala de estar/comedor: paraguas, albornoz.

Finalmente, razonaremos dónde debe ir cada objeto.

3. INGLÉS:

Ficha 1

NOMBRE _____ FECHA _____

1. Read the transcript and write the names of the buildings in each number.



2. Write four sentences using There is a..., There isn't a..., There are ... and There aren't ...

Respuesta libre

1. There is a hospital in my town.
2. There isn't a restaurant in my town.
3. There are three shops in my town.
4. There aren't four cinemas in my town.

1

Read and complete the sentences.



is isn't are aren't

- 1 There are four houses.
- 2 There aren't five shops.
- 3 There isn't a restaurant.
- 4 There is a hospital.

2

Look at the key and colour the sweets. Then, complete the sentences. **Child applies correct colours****key**

① = blue ② = red ③ = green



- 1 There are 13 blue sweets.
- 2 There are 11 red sweets.
- 3 There are 3 green sweets.